



# ELITE AIR CONDITIONER

INSTRUCTION MANUAL FOR THE AC1400 & AC1600





# ELITE AIR CONDITIONER

## DIAGRAMS FOR CORRECT INSTALLATION AND USE

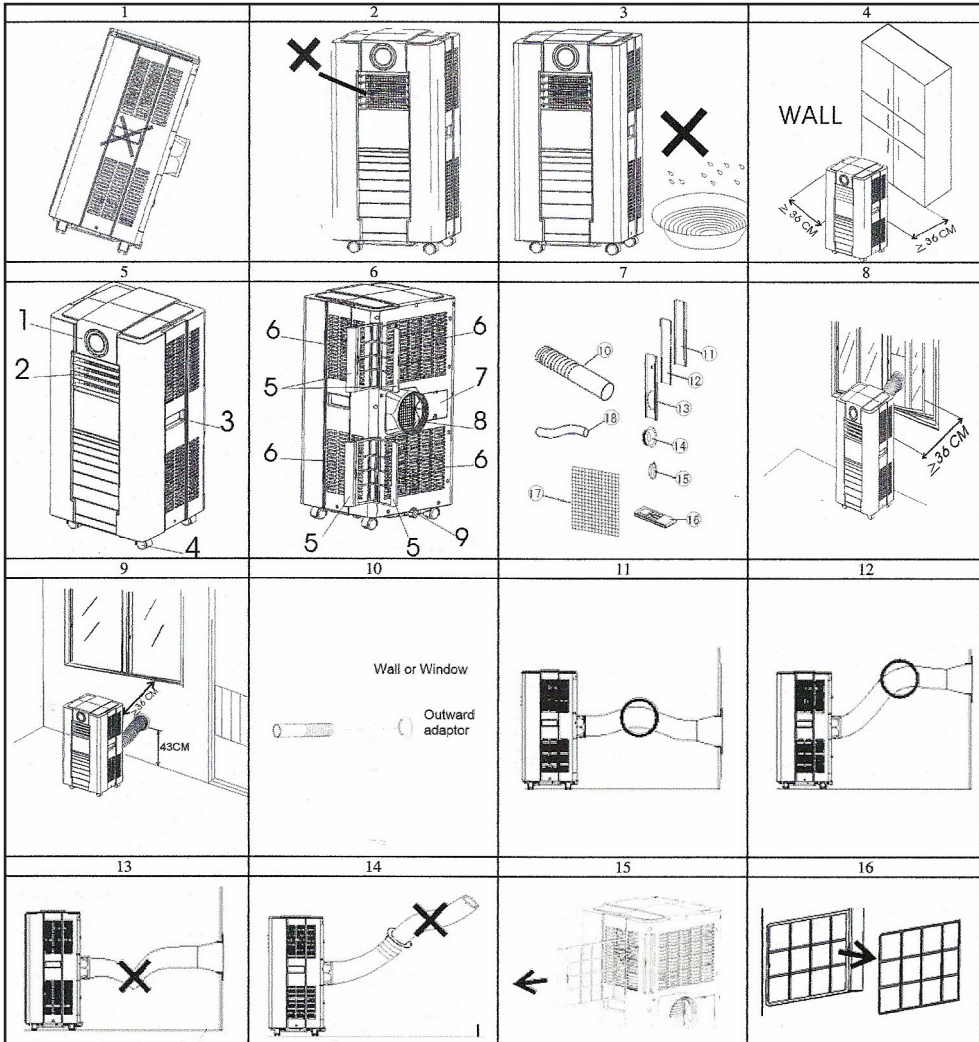

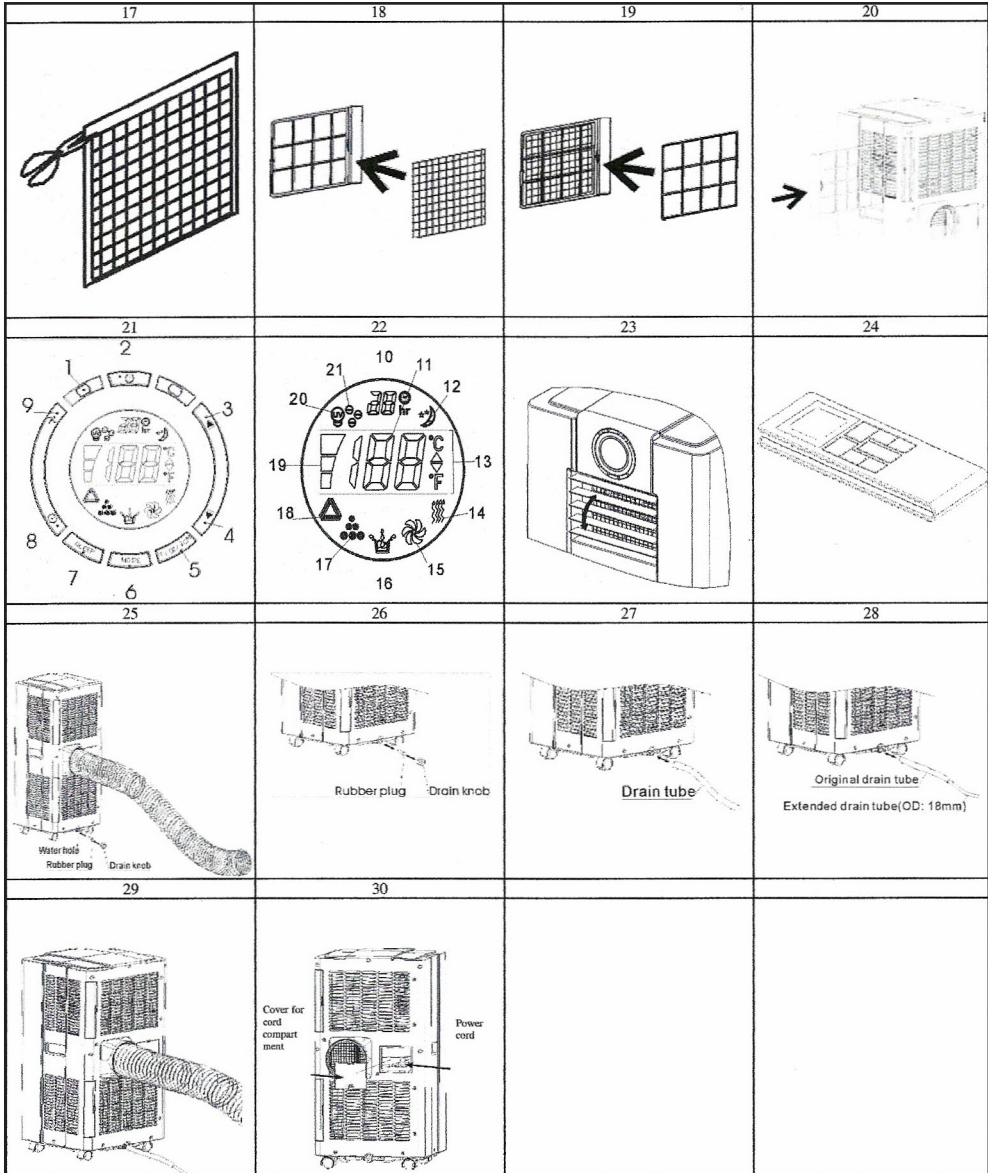



**Remark:**

1. Measuring condition for below is as per EN 14511: Cooling: DB;3SoC, WB; 24°C  
\*DB- temperature of dry bulb = room temperature,  
WB\* - temperature of web bulb = relative humidity
2. Test condition for data in our rating label is as per safety regulation: EN 60335-2-40
3. Current & Fuse: F2L2S0V or TIL2S0V

## TECHNICAL DATE

MODEL	AC1400	AC1600
Cooling capacity	14000BTU/hr 4.3kW	16000BTU/hr 4.7kW
Power/Ampere consumption for cooling	1650W/7.3A	1810W/8.1A
Air volume (max. speed)	525m <sup>3</sup> /h	550m <sup>3</sup> /h
Humidity removal capacity	1.4L/hour	1.7L/hour
Power supply	220-240V-. 50Hz	
Compressor	Rotary	
Refrigerant	R410A	
Fan speed	3	
Timer	1 - 24 hours	
Working temperature	Cooling:18- 32°C	
Exhaust pipe	142 x 1500mm	
Net Weight	33 kgs	35 kgs
Dimension	422 x 443 x 825 mm (W x D x H)	

**BEFORE USE - GENERAL SAFETY**

- ONLY USE IN THE UPRIGHT POSITION ON A FLAT LEVEL SURFACE AND AT LEAST 50cm FROM ANY OBJECTS (Fig. 1 & 4)
- DO NOT PLACE OBJECTS ON THE UNIT OR RESTRICT AIR INLET /OUTLET (Fig. 2).
- CLOSELY SUPERVISE ANY CHILDREN AND PETS WHEN UNIT IS IN USE.
- THIS APPLIANCE IS NOT INTENDED FOR USE BY PERSONS (INCLUDING CHILDREN) WITH REDUCED PHYSICAL, SENSORY OR MENTAL CAPABILITIES, OR LACK OF EXPERIENCE AND KNOWLEDGE, UNLESS THEY HAVE BEEN GIVEN SUPERVISION OR INSTRUCTION CONCERNING USE OF THE APPLIANCE BY A PERSON RESPONSIBLE FOR THEIR SAFETY. CHILDREN SHOULD BE SUPERVISED TO ENSURE THAT THEY DO NOT PLAY WITH APPLIANCE.

**ELECTRICAL SAFETY**

- FOR INDOOR USE ONLY.
- SWITCH OFF AND UNPLUG WHEN NOT IN USE.
- DO NOT USE IN HUMID OR WET ENVIRONMENTS (Fig. 3)
- DO NOT PULL THE UNIT ALONG BY THE CORD.
- IF THE SUPPLY CORD IS DAMAGED, IT MUST BE REPLACED BY AN ELECTRICIAN OR SIMILARLY QUALIFIED PERSON, TO AVOID HAZARD.

**FOR MAXIMUM Efficiency**

- CLOSE DOORS AND WINDOWS
- KEEP FILTERS CLEAN
- ONCE ROOM HAS REACHED THE DESIRED CONDITIONS, REDUCE TEMPERATURE AND VENTILATION SETTING

**PARTS****Front (Fig. 5)**

1. Control Panel
2. Air vent
3. Handle
4. Castor

**Back (Fig. 6)**

5. Air filter
6. Air inlet
7. Cord storage
- g. Outlet of exhaust air
9. Water stopper/outlet of condensed water

**Accessories (Fig. 7)**

10. Exhaust hose.
11. PVC strip - for fining The open window space.
12. PVC strip - for filling the open window space.
13. PVC strip (with hole) - for filling the open window space and with hole for connection to lie-in.

14. Outward adaptor - for insertion over hose and into PVC strip (or into hole in the wall/window).
15. Cover for outward adaptor.
16. Remote control.
17. Active carbon filter.
18. Tube for continuous drainage.

**INSTALLATION OF THE EXHAUST PIPE**

The unit is a local air conditioner that may be moved from room to room.

1. Using the PVC strip (Fig. 8)
2. Offer PVC strips to the window gap and adjust to size if necessary.
  - Connect one end of the exhaust pipe to outlet of exhaust air and the other end with the outward adapter.
  - Feed the exhaust hose to the PVC strip as shown and slide window across so that PVC strip is held securely. *Note:* Take care to maintain protection against intruders
3. Using the adaptor (Fig. 9, (0))
  - Cut a 151mm diameter hole in the wall or window.
  - Feed exhaust hose through the window or wall and attach the threaded adaptor from the outside as shown.
  - When not in use, plug the hole with the cover provided.

**MOUNTING OF THE EXHAUST PIPE (Fig. 11, 13)**

- Use only the hose provided and clip exhaust hose and unit adaptor to the back of the air conditioner.
- Avoid kinks and bends in the exhaust hose as this will cause expelled moist air to build up causing the unit to overheat and shut down. Fig 8 & 9 show correct position.
- The hose may be extended from 300mm to 1500mm but for maximum efficiency use the shortest length possible.

**WARNING! (Fig. 14)**

The length of the exhaust pipe is specially designed according to the specification of this product. Do not replace or prolong it with your own private hose as this could cause the unit to malfunction.

**Installation of the carbon filter (Fig. 15 - 20)**

1. Draw out the filter frame from the unit. (Fig 15)
2. Remove the filter fixer from the filter frame. (Fig. 16)
3. Remove the active carbon filter from its plastic bag. (Fig.17)
4. Attach the active carbon filter to the filter frame. (Fig.18)
5. Attach the filter fixer to the filter frame (the active carbon filter should be held between the filter frame and filter fixer firmly). (Fig. 19)
6. Insert the filter set (filter frame + active carbon filter + filter fixer) into the back of the unit. (Fig. 20)

## CONTROL PANEL

### Buttons (Fig. 21)

1. Receiver for remote control.
2. ON/OFF button.
3. Temperature increase button.
4. Temperature decrease button.
5. TI02/ION button.
6. MODE selection button.
7. SLEEP button.
8. TIMER button.
9. VENTILATION (fan speed) button.

### LCD signs (Fig. 22)

10. Sign for Timer (showing the working hour you set).
11. Room temperature display.
12. Sign for Sleep function.
13. Sign for Centigrade or Fahrenheit.
14. Sign for Heating function.
15. Sign for Ventilation mode.
16. Sign for Dry mode.
17. Sign for Cooling mode.
18. Sign for Automatic mode.
19. Sign for Ventilation speed (1 to 3 speeds).
20. Sign for Ti02.
21. Sign for Ionizer function.

## OPERATION.

### Turning ON/OFF

Adjust the Louvers to desired angle and position.

Press ON/OFF button, the unit will start to work.

If the ambient temperature is

- higher than 23°C the unit will work in cool mode.
- higher than 20°C but below or equal to 23°C the unit will work in ventilation model.
- below 20°C, the unit will work in heat function (This is for cooling & heating models only.),

Indicators of the functions in progress come on at the same time. \*NOTE! The display window shows the ambient room temperature from 0°C to 50°C

To turn the unit off. press ON/OFF button again, then close the air louvers.

### Setting mode/function

Press MODE button to select required working mode: automatic, cooling, fan or heat.

Indicator of the selected mode comes on.

### Setting temperature

1. Press Temperature up' or Temperature down' button to regulate the temperature you desired.
2. The display window will show the temperature you set as you press 'Temperature up' or Temperature down' button. Otherwise, it will always show the ambient temperature.
3. The pre-setting temperature of this machine is: 24°C for cooling.

### Setting ventilation speed

1. Press SPEED button to choose the ventilation speed you need. high, medium or low. The sign of high, low or medium ventilation will light on at the same time.
2. If the unit is in AUTO mode, it will choose the ventilation speed automatically according to the ambient temperature.

### Setting timer

1. Press TIMER button to set the operating hours you desired (1 to 24 hours, the sign of timer will light on). The window will show the hour(s) you set as you press TIMER button. If the timer button is not pressed. the unit will work continuously.
2. By pressing the timer but without turning on the other functions, you can PRE-SET the time for the machine to work. For example, if you press the timer to '2', the unit will work automatically after 2 hours.

### Sleep function

1. In cooling mode, by pressing the SLEEP button the set temperature will increase 1°C at the 1st hour. another 1°C In sleep mode, the ventilation will keep at low speed. Re-press the SLEEP button, the setting temperature and ventilation speed will return to the pre-selected one.
2. The unit will shut down automatically after the SLEEP function has been running for 12 hours.
3. **Please note, the sleep function is not available while the machine is working in ventilation. Only available in Cooling or Heating mode.**
4. **When the machine is in Sleep function, the ventilation would turn to be LOW.**

### Ti02/Ionizer function (option)

1. This is only for the model with Ti02 or Ionizer function, i.e. model no. with T or I. T stands for Ti02 (ultra-violet) I stands for Ionizer.
2. To start the Ti02 or Ionizer button, please press Ti02/Ionizer button. These two functions can clean the air, improve the air quality.

### Regulating air flow direction

Adjust the air louvers by hand to control the air flow direction. (Fig. 23).

### Self-diagnosis

This machine is equipped with self-diagnosis function.

If something is wrong in the machine, the display window will show the word "E1" or "E2". As this time, please call your service centre.

All the above functions can also be performed with the supplied remote control. (Fig. 24).

This remote control requires one button cell (No.CR2025) to operate.

**NOTICE!**

1. To prolong the compressor's life, after switch-off of the unit, please wait for 3 minutes (at least) before re-switch.
2. The cooling system will switch off if the ambient temperature is lower than the set one. The ventilation, however, keeps working on the set level. If the ambient temperature rises above the selected level, the cooling will return to work.

**DRAINAGE**

During the process of cooling, some water will be extracted from the air into the unit. If the tank is full, both of the compressor and motor will stop. The "water full" sign will light on, also the machine will beep as reminder.

To make the cooling work again, please empty the water by one of the following ways:

**Fig. 25**

1. Turn off the air conditioner and avoid moving it when full.
2. Position a container (a water tray for example) underneath the drain hole.
3. Remove the drain knob & rubber plug from the drain hole and allow the water to drain out.
4. When the container is almost full, replace the rubber plug in the drain hole and empty the water tray.
5. Repeat until the unit is emptied.
6. Replace the rubber plug and tighten the drain knob firmly.
7. Switch on the unit - the full water or compressor operating indicator should not be flashing.

If you wish to operate the unit without the need to empty the water tank, please:

**Fig 26.**

Remove the drain knob and rubber plug and retain for future use.

Connect the drain tube supplied to the water outlet as shown and locate the other end into drain.

**Fig. 27.**

The drain tube may be extended by adding an extension tube and using a suitable connector.

**Please note (Fig. 28.)**

1. The drain must be at or below the outlet level.
2. Flashing comp / 'full water' indicator will not function in this mode of drainage.
3. If you want to extend the water tube, you can connect it with another tube (OD: 18mm)

**MAINTENANCE**

**Always unplug the air conditioner from the mains before cleaning. To maximise the efficiency of the air conditioner clean regularly.**

**Cleaning the housing**

Use a soft, damp cloth to wipe the body clean. Never use aggressive chemicals, gasoline, detergents, chemically treated cloths, or other cleansing solutions. These all could possibly damage the cabinet.

**Cleaning the filter**

Use a vacuum cleaner or tap the filter lightly to remove loose dust and dirt from the filters and then rinse thoroughly under running water (no hotter than 40°C).

Dry thoroughly before replacing.

*Notice!* Never operate the unit without the filters.

**End of season storage (Fig. 30)**

Drain any water in the unit before completely operating the unit on ventilation only mode for a few hours, to thoroughly dry the inside.

Clean or change the filter.

Unplug and store the power cord as shown.

Cover the cord storage.

Place in the original carton or cover-for storage.

**FAULT CHECK LIST**

*The air conditioner does not run:*

Is the air conditioner plugged in?

Is there a power failure?

Is the comp/'full water' indicator flashing?

Is the room temperature below the set temperature?

*The machine seems to do little:*

Is there direct sunshine? (please put down the curtain.)

Are too many windows or doors open?

Are there too many people in the room?

Is there something in the room producing lots of heat?

*The machine seems to do nothing:*

Is the filter dusty, contaminated?

Is the air intake or output blocked up?

Is the room temperature below your selected temperature?

*Too noisy:*

Is the machine positioned unevenly so as to create vibration?

Is the floor underneath the machine uneven?

*The compressor doesn't run:*

If so, it is possible the overheat protection of the compressor is on. Just wait for the temperature to drop.

**Never try to repair or dismantle the unit yourself**

**EC Declaration of Conformity** In accordance with EN ISO 17050-1:2004

We The Hire Supply Company  
of Building No 2, Sheet Stores Ind Est, Long Eaton NG10 1AU

*in accordance with the following Directive(s):*

2014/35/EU The Low Voltage Directive  
2014/30/EU The Electromagnetic Compatibility Directive  
2011/65/EU RoHS Directive

*hereby declare that:*

Equipment Elite Air Conditioners  
Model number AC1400, AC1600

*is in conformity with the applicable requirements of the following documents*

Ref. No.	Title	Edition/date
EN 60335-2-40	Household and similar electrical appliances. Safety. Particular requirements for electrical heat pumps, air-conditioners and dehumidifiers	A13:2012
EN 60335-1	Household and similar electrical appliances. Safety. General requirements	A11:2014
EN 62233	Measurement methods for electromagnetic fields of household appliances and similar apparatus with regard to human exposure	2008
EN 55014-1	Electromagnetic compatibility. Requirements for household appliances, electric tools and similar apparatus. Emission	A2:2011
EN 55014-2	Electromagnetic compatibility. Requirements for household appliances, electric tools and similar apparatus. Immunity. Product family standard	A2:2008
EN 61000-3-2	Electromagnetic compatibility (EMC). Limits. Limits for harmonic current emissions (equipment input current $\leq 16$ A per phase)	A2:2009
EN 61000-3-3	Electromagnetic compatibility (EMC). Limits. Limitation of voltage changes, voltage fluctuations and flicker in public low-voltage supply systems, for equipment with rated current $\leq 16$ A per phase and not subject to conditional connection	2008
EN 61000-3-11	Electromagnetic compatibility (EMC). Limits. Limitation of voltage changes, voltage fluctuations and flicker in public low-voltage supply systems. Equipment with rated voltage current $\leq 75$ A and subject to conditional connection	2000



**THE HIRE SUPPLY COMPANY**

Building No. 2, Sheet Stores Industrial Estate, Off Fields Farm Road, Long Eaton, Nottingham NG10 1AU

Telephone: 0115 946 1988 • Fax: 0115 946 3541