

5800 SB
2010-2016

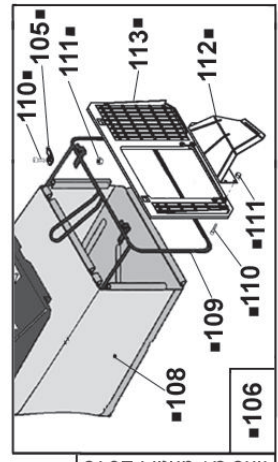

fino a / until : 2013

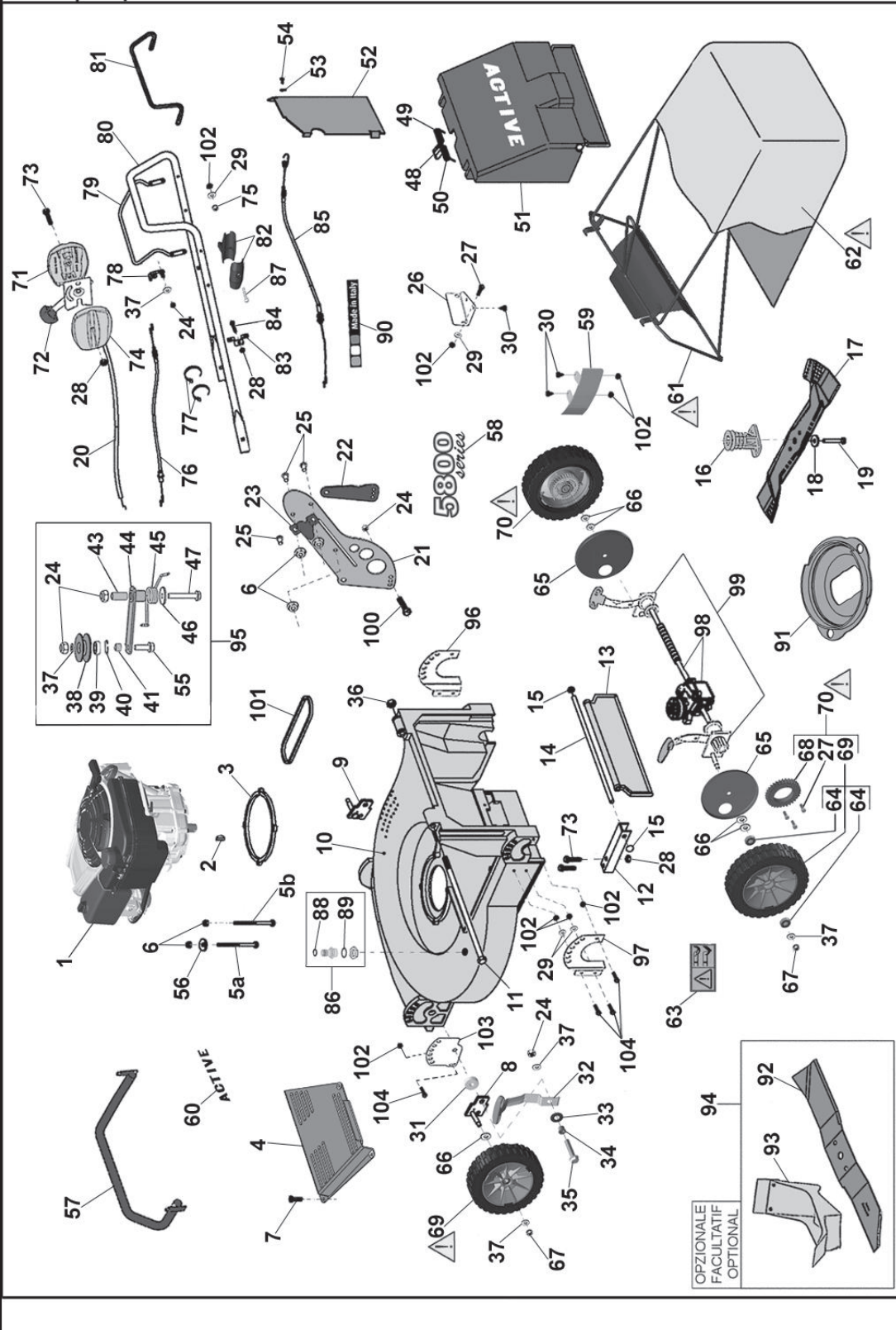
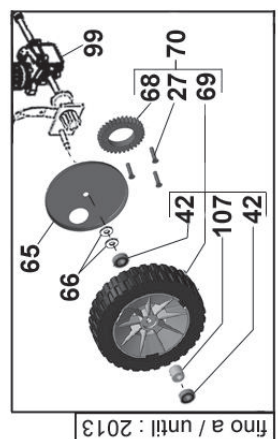

fino a / until : 2013

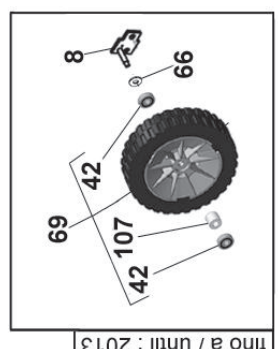

fino a / until : 2013

Rasaerba - Tondeuses - Lawn mowers (5800 SB)

RIF.	COD.	Q.	DESCRIZIONE - DESCRIPTION	RIF.	COD.	Q.	DESCRIZIONE - DESCRIPTION
REF.	N° / P P / N°			REF.	N° / P P / N°		
1	50602	1	MOTORE - MOTEUR - ENGINE (B&S 675)	60	50762	1	ADESIVO ACT/VE - MARQUE - BRAND
	50243		MOTORE - MOTEUR - ENGINE (B&S 850)	61	50058	1	TELAIO - CHASSIS - FRAME
2	50306	1	CHIAVETTA - CLAVETTE - KEY	62	50697	1	TELA - TOILE - CANVAS (Verde - Green)
3	51173	1	FLANGIA - FLASQUE - FLANGE		50817		TELA - TOILE - CANVAS (Nero - Black)
4	50224	1	CARTER - CAPOT - HOUSING	63	50909	1	ADESIVO - ADHESIF - ADHESIVE
5a	40290	2	VITE - VIS - SCREW	64	50155	8	CUSCINETTO - ROULEMENT - BEARING
5b	40291	1	VITE - VIS - SCREW	65	50174	2	PARAPOLVERE - PROTECTION - GUARD
6	50666	9	DADO - ECROU - NUT	66	20790	6	RASAMENTO - RONDELLE - WASHER
7	50645	5	VITE - VIS - SCREW	67	50663	4	DADO - ECROU - NUT
8	50088	1	PIASTRA - PLAQUE - PLATE (SX - ANT.)	68	50529	2	CORONA - COURONNE - CROWN
9	50012	1	PIASTRA - PLAQUE - PLATE (DX - ANT.)	69	50702	2	RUOTA - ROUE - WHEEL
10	50591	1	CARTER - CAPOT - HOUSING (Grigio - Gray)	70	50684	2	KIT: RUOTA - ROUE - WHEEL
	50221		CARTER - CAPOT - HOUSING (Rosso - Red)	71	50104	1	CARTER (DX)
11	50087	1	TIRANTE - TIRAGE - STAY BAR	72	50094	1	LEVA GAS - LEVIER GAS - GAS LEVER
12	50090	2	STAFFA - PALIER - BRACKET	73	20190	5	VITE - VIS - SCREW
13	50769	1	FLAP	74	50545	1	CARTER (SX)
14	50770	1	PERNO - PIVOT - PIN	75	20917	2	DADO - ECROU - NUT
15	50301	2	STARLOCK	76	50095	1	CAVO - CABLE (Freno - Brake)
16	50608	1	MOZZO - MOYEUR - HUB (Ø 25)	77	50314	2	FASCETTA - CLIP
17	50195	1	LAMA - LAME - BLADE (55 cm)	78	50105	1	GUIDA ZONE START - MANCHERON - HANDLE
18	50538	1	RONDELLA - RONDELLE - WASHER	79	51268	1	MANIGLIA - POIGNEE - HANDLE
19	50641	1	VITE - VIS - SCREW	80	50125	1	MANUBRIO - MANCHERON - UPPER HANDLE
20	50069	1	CAVO - CABLE (Gas) (B&S 675)	81	51285	1	MANIGLIA - POIGNEE - HANDLE
	50712		CAVO - CABLE (Gas) (B&S 850)	82	50617	2	STAFFA - PALIER - BRACKET
21	50748	2	PIASTRA - PLAQUE - PLATE	83	50206	1	STAFFA - PALIER - BRACKET
22	50760	2	DISTANZIALE - ENTRETOISE - SPACER	84	40092	1	VITE - VIS - SCREW
23	50750	2	SUPPORTO - SUPPORT - MOUNTING	85	50383	1	CAVO - CABLE (Trazione - Traction)
24	20788	7	DADO - ECROU - NUT	86	51158	1	ATTACCO ACQUA - RACCORDEMENT à L'EAU - WATER CONNECTION (M 16)
25	40007	6	VITE - VIS - SCREW		50209		ATTACCO ACQUA - RACCORDEMENT à L'EAU - WATER CONNECTION (M 20)
26	50220	1	STAFFA - PALIER - BRACKET	87	22045	2	VITE - VIS - SCREW
27	20328	8	VITE - VIS - SCREW	88	23755	1	GOMMINO - CAOUTCHOUC - RUBBER
28	20176	6	DADO - ECROU - NUT	89	50511	1	GOMMINO - CAOUTCHOUC - RUBBER (M16)
29	21139	8	RONDELLA - RONDELLE - WASHER		23758		GOMMINO - CAOUTCHOUC - RUBBER (M20)
30	20272	4	VITE - VIS - SCREW	90	51171	1	ADESIVO - MARQUE - BRAND
31	50780	2	DISTANZIALE - ENTRETOISE - SPACER	91	50063	1	CARTERINO - COUVERCLE - COVER
32	50013	2	LEVA - LEVIER - LEVER	92	50893	1	LAMA - LAME - BLADE (Mulching)
33	50308	2	MOLLA - RESSORT - SPRING	93	50947	1	TAPPO MULCHING - FERMATURE - MULCHING PLUG
34	50290	2	BOCCOLA - ANNEAU - SPACER	94	50473	1	KIT MULCHING (OPTIONAL - FACULTATIF)
35	40392	2	VITE - VIS - SCREW	95	50872	1	KIT : GALOPPINO - TENDEUR - TENSIONER
36	20317	1	DADO - ECROU - NUT	96	50936	1	PIASTRA - PLAQUE - PLATE (DX - POST.)
37	20711	8	RONDELLA - RONDELLE - WASHER	97	50938	1	PIASTRA - PLAQUE - PLATE (SX - POST.)
38	50262	1	PULEGGIA - POULIE - PULLEY	98	50326	1	TRASMISSIONE - BOITE DE VIT. - GEARBOX (pulley Ø57)
39	22682	1	CUSCINETTO - ROULEMENT - BEARING		50776		TRASMISSIONE - BOITE DE VIT. - GEARBOX (pulley Ø71)
40	50315	1	SEEGER	99	50956	1	KIT: TRASMISSIONE - BOITE DE VIT. - GEARBOX (pulley Ø57)
41	50765	1	BOCCOLA - ANNEAU - SPACER		50218		KIT: TRASMISSIONE - BOITE DE VIT. - GEARBOX (pulley Ø71)
42	50667	8	CUSCINETTO - ROULEMENT - BEARING	100	40720	2	VITE - VIS - SCREW
43	50767	1	BOCCOLA - ANNEAU - SPACER	101	50086	1	CINGHIA - COURROIE - BELT (pulley Ø57)
44	50232	1	LEVA - LEVIER - LEVER		50679		CINGHIA - COURROIE - BELT (pulley Ø71)
45	50311	1	MOLLA - RESSORT - SPRING	102	20289	14	DADO - ECROU - NUT
46	21686	1	RONDELLA - RONDELLE - WASHER	103	50934	2	PIASTRA - PLAQUE - PLATE (ANT.)
47	20786	1	VITE - VIS - SCREW	104	35792	8	VITE - VIS - SCREW
48	50018	1	GOMMINO - CAOUTCHOUC - RUBBER	105	50193	2	PIASTRA - PLAQUE - PLATE
49	50023	1	MOLLA - RESSORT - SPRING (DX)	106	50191	1	CEST. COMP. - FABRIC CATCHER - BAC EN TOILE (Verde - Green)
50	50618	1	MOLLA - RESSORT - SPRING (SX)		50827		CEST. COMP. - FABRIC CATCHER - BAC EN TOILE (Nero - Black)
51	50031	1	DEFLETTORE - DEFLECTEUR - DEFLECTOR	107	50544	4	DISTANZIALE - ENTRETOISE - SPACER
52	50227	1	CARTERINO - COUVERCLE - COVER	108	50192	1	TELA - TOILE - CANVAS (Verde - Green)
53	20316	1	RONDELLA - RONDELLE - WASHER		50726		TELA - TOILE - CANVAS (Nero - Black)
54	50657	1	VITE - VIS - SCREW	109	50543	1	TELAIO - CHASSIS - FRAME
55	40370	1	VITE - VIS - SCREW	110	20064	6	VITE - VIS - SCREW
56	40229	2	RONDELLA - RONDELLE - WASHER	111	20060	6	DADO - ECROU - NUT
57	50918	1	PROTEZIONE - PROTECTION - GUARD	112	50196	1	TEGOLO - PLAQUE - GRILLE SPOON
58	50637	1	ADESIVO - MARQUE - BRAND	113	50092	1	RETE - GRILLE
59	50567	1	PIASTRA - PLAQUE - PLATE				

5800 SB

2017



Rasaerba - Tondeuses - Lawn mowers (5800 SB)

RIF. REF.	COD. N° / P P / N°	Q.	DESCRIZIONE - DESCRIPTION	RIF. REF.	COD. N° / P P / N°	Q.	DESCRIZIONE - DESCRIPTION
1	50243	1	MOTORE - MOTEUR - ENGINE (B&S 850)	52	50227	1	CARTERINO - COUVERCLE - COVER
2	50306	1	CHIAVETTA - CLAVETTE - KEY	53	50934	2	PIASTRA - PLAQUE - PLATE
3	51173	1	FLANGIA - FLASQUE - FLANGE	54	50657	1	VITE - VIS - SCREW
4	50224	1	CARTER - CAPOT - HOUSING	55	40370	1	VITE - VIS - SCREW
5a	40290	2	VITE - VIS - SCREW	56	40229	2	RONDELLA - RONDELLE - WASHER
5b	40291	1	VITE - VIS - SCREW	57	50918	1	PROTEZIONE - PROTECTION - GUARD
6	50666	9	DADO - ECROU - NUT	58	51303	1	ADESIVO - MARQUE - BRAND
7	50645	5	VITE - VIS - SCREW	59	50567	1	PIASTRA - PLAQUE - PLATE
8	50088	1	PIASTRA - PLAQUE - PLATE (SX - ANT.)	60	50762	1	ADESIVO ACTIVE - MARQUE - BRAND
9	50012	1	PIASTRA - PLAQUE - PLATE (DX - ANT.)	61	50058	1	TELAIO - CHASSIS - FRAME
10	51315	1	CARTER - CAPOT - HOUSING (Grigio - Gray)	62	50697	1	TELA - TOILE - CANVAS (Verde - Green)
	50221		CARTER - CAPOT - HOUSING (Rosso - Red)		50817		TELA - TOILE - CANVAS (Nero - Black)
11	50087	1	TIRANTE - TIRAGE - STAY BAR	63	50909	1	ADESIVO - ADHESIF - ADHESIVE
12	20290	4	VITE - VIS - SCREW	64	50155	8	CUSCINETTO - ROULEMENT - BEARING
13	51255	2	PIASTRA - PLAQUE - PLATE	65	50174	2	PARAPOLVERE - PROTECTION - GUARD
14	20289	14	DADO - ECROU - NUT	66	20790	6	RASAMENTO - RONDELLE - WASHER
15	50086	1	CINGHIA - COURROIE - BELT	67	50663	4	DADO - ECROU - NUT
16	50608	1	MOZZO - MOYEUR - HUB (Ø 25)	68	50529	2	CORONA - COURONNE - CROWN
17	50195	1	LAMA - LAME - BLADE (55 cm)	69	50702	2	RUOTA - ROUE - WHEEL
18	50538	1	RONDELLA - RONDELLE - WASHER	70	50684	2	KIT: RUOTA - ROUE - WHEEL
19	50641	1	VITE - VIS - SCREW	71	50104	1	CARTER (DX)
20	50712	1	CAVO - CABLE (Gas)	72	50094	1	LEVA GAS - LEVIER GAS - GAS LEVER
21	50748	2	PIASTRA - PLAQUE - PLATE	73	20190	1	VITE - VIS - SCREW
22	50760	2	DISTANZIALE - ENTRETOISE - SPACER	74	50545	1	CARTER (SX)
23	50750	2	SUPPORTO - SUPPORT - MOUNTING	75	20917	2	DADO - ECROU - NUT
24	20788	7	DADO - ECROU - NUT	76	50095	1	CAVO - CABLE (Freno - Brake)
25	40007	6	VITE - VIS - SCREW	77	50314	2	FASCETTA - CLIP
26	50220	1	STAFFA - PALIER - BRACKET	78	50105	1	GUIDA ZONE START - MANCHERON - HANDLE
27	20328	8	VITE - VIS - SCREW	79	51268	1	MANIGLIA - POIGNEE - HANDLE
28	20176	6	DADO - ECROU - NUT	80	50125	1	MANUBRIO - MANCHERON - UPPER HANDLE
29	21139	8	RONDELLA - RONDELLE - WASHER	81	51285	1	MANIGLIA - POIGNEE - HANDLE
30	20272	4	VITE - VIS - SCREW	82	50617	2	STAFFA - PALIER - BRACKET
31	50780	2	DISTANZIALE - ENTRETOISE - SPACER	83	50206	1	STAFFA - PALIER - BRACKET
32	50013	2	LEVA - LEVIER - LEVER	84	40092	1	VITE - VIS - SCREW
33	50308	2	MOLLA - RESSORT - SPRING	85	50383	1	CAVO - CABLE (Trazione - Traction)
34	50290	2	BOCCOLA - ANNEAU - SPACER	86	51158	1	ATTACCO ACQUA - RACCORDEMENT à L'EAU - WATER CONNECTION
35	40392	2	VITE - VIS - SCREW	87	22045	2	VITE - VIS - SCREW
36	20317	1	DADO - ECROU - NUT	88	23755	1	GOMMINO - CAOUTCHOUC - RUBBER
37	20711	8	RONDELLA - RONDELLE - WASHER	89	50511	1	GOMMINO - CAOUTCHOUC - RUBBER
38	50262	1	PULEGGIA - POULIE - PULLEY	90	51171	1	ADESIVO - MARQUE - BRAND
39	22682	1	CUSCINETTO - ROULEMENT - BEARING	91	50063	1	CARTERINO - COUVERCLE - COVER
40	50315	1	SEEGER	92	50893	1	LAMA - LAME - BLADE (Mulching)
41	50765	1	BOCCOLA - ANNEAU - SPACER	93	50947	1	TAPPO MULCHING - FERMATURE - MULCHING PLUG
42	35792	8	VITE - VIS - SCREW	94	50473	1	KIT MULCHING (OPTIONAL - FACULTATIF)
43	50767	1	BOCCOLA - ANNEAU - SPACER	95	50872	1	KIT : GALOPPINO - TENDEUR - TENSIONER
44	50232	1	LEVA - LEVIER - LEVER	96	50936	1	PIASTRA - PLAQUE - PLATE (DX - POST.)
45	50311	1	MOLLA - RESSORT - SPRING	97	50938	1	PIASTRA - PLAQUE - PLATE (SX - POST.)
46	21686	1	RONDELLA - RONDELLE - WASHER	98	50326	1	TRASMISSIONE - BOITE DE VIT. - GEARBOX
47	20786	1	VITE - VIS - SCREW	99	50956	1	KIT: TRASMISSIONE - BOITE DE VIT. - GEARBOX
48	50018	1	GOMMINO - CAOUTCHOUC - RUBBER	100	40720	2	VITE - VIS - SCREW
49	50023	1	MOLLA - RESSORT - SPRING (DX)	101	51294	2	CARTER
50	50618	1	MOLLA - RESSORT - SPRING (SX)	102	51304	1	ADESIVO - MARQUE - BRAND
51	50031	1	DEFLETTORE - DEFLECTEUR - DEFLECTOR	103	35948	2	VITE - VIS - SCREW