

ORIGINAL INSTRUCTIONS

CAUTION – READ THESE INSTRUCTIONS BEFORE USING
THE MACHINE

Hydromist Lite

Carpet soil extraction machines



USER MANUAL EN

BEDIENUNGSANLEITUNG DE

MANUEL D'UTILISATION FR

IMPORTANT
BEFORE USE READ THESE INSTRUCTIONS AND RETAIN FOR FUTURE REFERENCE

INTRODUCTION

The following instructions contain important information about the machine and safety advice for the operator. Equipment must be operated, serviced and maintained in accordance with the manufacturer's instructions. If in doubt contact the supplier of your machine.



Read all instructions before using the machine

PRODUCT INFORMATION

The Hydromist range of carpet soil extraction machines are designed for the efficient cleaning of carpets and upholstery. This machine is for indoor use only. The machine is intended for commercial use, for example in hotels, schools, hospitals, factories, shops, offices, rental businesses and other than normal housekeeping purposes.

TECHNICAL SPECIFICATIONS

Model		Hydromist Lite
Product Code		HML
Voltage AC (~)/ Frequency	V/Hz	230/50-60
Vacuum Motor Power	W	1200
Airflow rate	l/s	46.1
Solution Flow rate	l/min	2
Vacuum / Water lift	kPa / mmwg	22 / 2243
Solution tank capacity	litres	6.5
Recovery tank capacity	litres	7
Pump type		Magnet
Pump power	W	50
Pump pressure	bar/psi	4 / 58
Sound pressure level	dB(A)	78
Dimensions (L x W x H)	cm	53 x 37 x 43
Weight	kg	10
Hose length	m	3
Cable length	m	4.5
Warranty		1 year subject to conditions

- Handle vibration does not exceed 2.5 m/s² when operating on a smooth floor surface.
- Noise levels measured at a distance of 1 metre from machine and 1.6 metres above floor, when operating on a hard floor. Measurements recorded using a hand held meter.
- Above dimensions are approx. Since the company's policy is to continuously improve the product, there could be changes without prior notice.

EC Declaration of Conformity

Machine Type: Carpet soil extraction machines
 Model: HML...

This machine is in conformity with the following EU directives:

- Machinery Directive 2006/42/EC
- The EMC Directive 2014/30/EU

Applied harmonised standards:

EN60335-1, EN60335-2-68, EN55014-1, EN55014-2, EN62233, EN610003-2, EN610003-3

Truvox International Limited
 Unit C (East), Hamilton Business Park,
 Manaton Way, Botley Road,
 Hedge End, Southampton,
 SO30 2JR, UK

M. Eneas

Malcolm Eneas
 Operations Manager
 Southampton, 21/08/2018

WASTE ELECTRICAL & ELECTRONIC EQUIPMENT (WEEE)



DO NOT dispose of this device with unsorted waste. Improper disposal may be harmful to the environment and human health. Please refer to your local waste authority for information on return and collection systems in your area.

IMPORTANT SAFETY ADVICE

The safety information described in this manual provides basic precautions and supplements standards in force in the country where the machine is used.



This symbol warns the operator of hazards and unsafe practices which could result in severe personal injury or death.



WARNING – to reduce the risk of injury, electric shock or fire.

1. This machine must only be used for the manufacturer's approved application as described in this manual.
2. The machine must be unpacked and assembled in accordance with these instructions before connecting to the electrical supply.
3. Only genuine accessories and spare parts provided with the machine or those approved by the manufacturer should be used. The use of other accessories may impair the safety of the machine. All repairs must be performed by a qualified service agent.
4. **DO NOT** modify the machine from its original design.
5. Operators must be fully trained in the use of the machine in accordance with these instructions, able to perform regular user maintenance and the correct selection of accessories.
6. Operators should be physically capable to manoeuvre, transport and operate the machine.
7. Operators should be able to recognise unusual operation of the machine and report any problems.
8. This machine is not intended for use by persons (including children) with reduced physical, sensory or mental capabilities, or lack of experience and knowledge, unless they have been given supervision or instruction concerning use of the machine by a person responsible for their safety.
9. Keep children and unauthorised persons away from the machine when in use. **DO NOT** use as a toy.
10. **DO NOT** use if it has been damaged, left outdoors or dropped in water.

11. **DO NOT** use where hazardous dust is present.
12. **DO NOT** use in an explosive atmosphere.
13. **DO NOT** pick up or use near flammable or combustible fluids, hazardous dusts or vapours.
14. **CAUTION** - If it is suspected that there is hazardous dust or flammable/corrosive material, stop cleaning the area immediately and consult your superior.
15. **DO NOT** use to clean up any burning or lighted materials such as cigarettes, matches, ashes or other combustible objects.
16. Only use the machine on firm level surfaces. **DO NOT** use on a gradient or slope of more than 2%.
17. **DO NOT** use on rough uneven surfaces e.g. industrial or coarse concrete surfaces.
18. **DO NOT** use outdoors e.g. on patios, decks or rough surfaces.
19. **CAUTION** - This machine is for dry indoor use only and should not be used or stored outdoors in wet conditions.
20. Take care when using a machine near the top of stairs to avoid overbalancing.
21. **DO NOT** cover the machine when in use.
22. **DO NOT** leave machine running unattended.
23. **DO NOT** wash and vacuum corrosive, flammable and/ or explosive liquids, even if diluted.
24. **WARNING** - Should foam/liquid emit from the machine exhaust, switch off immediately.
25. Keep hair, loose clothing, hands, feet and all other parts of the body away from openings and moving parts.
26. **DO NOT** put any object into openings. **DO NOT** use with any opening blocked; keep free of dust, debris and anything that may reduce airflow.
27. **DO NOT** use volatile or combustible solvents (e.g. diesel/petrol/IPA/trichloromethane) nor any corrosive, toxic or highly irritant substances to wash floors, even if diluted. In the event of accidental contact with any such substances(e.g. due to spills) follow the decontamination procedures in force at the user site.If in any doubt about the condition of the machine, contact Truvox or the dealer/agent who supplied the machine.
28. Wear suitable footwear to avoid slipping.
29. **DO NOT** operate the machine if it malfunctions or is damaged in any way. Contact an authorised service agent for repair or adjustments.
30. **DO NOT** leave the machine connected to the electricity supply when not in use, always remove the plug from the socket-outlet.
31. **WARNING DO NOT** fill the machine with water hotter than 40°C.
32. Never use excessive foaming or highly corrosive cleaning solutions.
33. Warm water can be used to aid cleaning, however this can increase the risk of colours fading and carpets to shrink.

ELECTRICAL HAZARD



34. **DO NOT** operate the machine with a damaged power cord or plug, or after the machine malfunctions or is damaged in any way. Contact an authorised Service Agent for repair or adjustment.

35. The machine must be kept clean and in good condition with regular inspections of the power cord and plug for signs of any damage. If any parts are damaged they shall only be replaced by an approved part by the manufacturer, its service agent or a similar qualified person in order to avoid a hazard.
36. Only replace the power cord with the type specified in the instruction manual.
37. When unplugging, pull the plug, not the power cord.
38. **WARNING:** Keep the power cord clear of moving parts.
39. **DO NOT** kink or twist the power cord and keep cord away from heated surfaces.
40. The power cord plus any extension leads should not exceed 30 metres in total. The cross section of an extension cable wiring must be at least 2.5mm².
41. **DO NOT** pull or carry by the power cord. **DO NOT** use cord as a handle, close door on cord or pull cord around sharp edges or corners.
42. Switch off the machine before removing the plug.
43. **DO NOT** operate switches or touch the mains plug with wet hands as this may cause electric shock.
44. This machine should always be connected to a fully earthed power supply of the right voltage and frequency.
45. The machine shall be disconnected from its power source when not in use and before commencing cleaning of the machine or maintenance and when replacing parts or accessories, by removing the plug from the socket-outlet.

CLEANING AGENTS

1. When using cleaning and care agents, the manufacturer's danger warnings must be followed and protective goggles and clothing must be worn.
2. Only use low-foaming, non-combustible cleaning agents which do not contain generally health-hazardous substances.
3. Please ensure that after each use any chemical residue is rinsed out with clean water.

TRANSPORTING THE MACHINE

- Take extreme care when moving the machine up or down steps or stairs.
- Incorrect lifting techniques may result in personal injury. We advise that the manual handling regulations are followed. Carefully wrap the power cord and store in dry indoor location.
- **DO NOT** expose the machine to rain or moisture.
- When transporting the machine ensure that all components, tanks and removable parts are securely fastened, and that the power cord and plug are not trailing.
- **DO NOT** attempt to lift the machine without assistance.
- **DO NOT** lift or transport the machine whilst containing liquid as this will add considerably to the weight.

STORAGE

- Always switch off the machine after use.
- Store the machine in a dry indoor area only.
- Wrap the power cord around the handlebar ensuring that the plug is not trailing on the floor.
- Always switch off, empty, wipe down and dry the machine after use.

- Both the solution and recovery tanks should be emptied and flushed out with clean water to ensure the seals and pumps are free from any cleaning detergents.
- **IMPORTANT** – To dispose of unused cleaning solution, comply with the standards in force in the country in which the machine is being used.
- We recommend running the vacuum motor for approx. 2 minutes after use to eliminate condensation within the machine body, thus ensuring the motor and particularly the bearings remain dry.

MAINTENANCE



WARNING - Before undertaking maintenance operations or adjustments switch off machine and unplug from the electricity supply.

IMPORTANT – All other servicing and repairs should only be performed by a Truvox engineer or Authorised Service Agent.

IMPORTANT – Should the machine fail to operate please refer to the fault diagnosis section in the back of this instruction manual. If the problem / remedy is not listed please contact Truvox Customer Service Department for rapid attention.

The machine requires minimum maintenance apart from the following checks by the operator prior to use:

- Body of the machine - Clean with a damp cloth.
- Power cord - Regularly inspect sheath, plug and cord anchorage for damage or loose connection. Only replace the power cord with the type specified in these instructions.
- Solution tank - Check water flow, if restricted inspect hoses and tubes for blockage or kinks.
- Solution tank – Check filter is clean and undamaged. A damaged or missing filter must be replaced or damage to pump head and spray jet could occur.
- Vacuum filter – Check the vacuum filter is clean and replace as appropriate.
- Hose, wand and vacuum accessories – Check and remove any debris or lint build-up from the head.
- Spray jet – Check jet for blockage and full spray pattern. Blow through jet to clean. **DO NOT** use a pin, as this could damage the jet.
- Before removing the spray hose, pressure in the system must be released. With the pump switched off, hold the spray nozzle over the removable recovery tank and squeeze the spray trigger until the remaining solution has been released. The spray hose can now be disconnected.

AFTER SALES SERVICE

Truvox machines are high quality machines that have been tested for safety by authorised technicians. It is always apparent that after longer working periods, electrical and mechanical components will show signs of wear and tear or ageing. To

maintain operational safety and reliability the following service interval has been defined: Every year or after 250 hours. Under extreme or specialised conditions and/or insufficient maintenance, shorter maintenance intervals are necessary. Use only original Truvox spare parts. Use of other spare parts will invalidate all warranty and liability claims. Should you require after sales service please contact the supplier from whom you purchased the machine, who will arrange service. Repairs and servicing of Truvox products should only be performed by trained staff. Improper repairs can cause considerable danger to the user.

GUARANTEE

Your product is guaranteed for one year from the date of original purchase, or hire purchase, against defects in materials or workmanship during manufacture. Within the guarantee period we undertake at our discretion, to repair or replace free of charge to the purchaser, any part found to be defective, subject to the following conditions:

CONDITIONS

1. Claims made under the terms of the guarantee must be supported by the original invoice/bill of sale issued at the time of sale, or the machine Serial No.
2. For claims under this guarantee contact the supplier from whom you purchased the product who will arrange the appropriate action. Do not initially return the product as this could result in transit damage.
3. Neither Truvox nor its distributor shall be liable for any incidental or consequential loss.
4. This guarantee is governed by the laws of England.
5. This guarantee does not cover any of the following:
 - Periodic maintenance, and repair or replacement of parts due to normal wear and tear.
 - Damage caused by accident, misuse or neglect, or the fitting of other than genuine Truvox parts.
 - Defects in other than genuine Truvox parts, or repairs, modifications or adjustments performed by other than a Truvox service engineer or authorised service agent.
 - Costs and risks of transport relating directly or indirectly to the guarantee of this product.
 - Consumable items such as power cords, brushes, drive discs, filters, belts, vacuum skirts and other similar items.

This guarantee does not affect your statutory rights, or your rights against the supplier arising from their sales or purchase contract. Truvox International Limited policy is one of continual product development and we reserve the right to alter specifications without prior notice.

RECOMMENDED SPARES & ACCESSORIES

	HML
Wand	20-0155-0000
Hose assembly. Solution and vacuum hose.	20-0153-0000
Tool set. Upholstery tool and carpet tool	20-0156-0000
Hose bag for storage of hose and upholstery tool	03-6029-0000

FAULT DIAGNOSIS

The following simple checks may be performed by the operator. If the machine is still not working, please contact your local Service Agent:

Trouble	Reason	Remedy
The spray pump and vacuum does not work	<ul style="list-style-type: none"> Lack of voltage/electrical supply 	<ul style="list-style-type: none"> Check fuse *, power cord, plug and socket outlet
Machine is not spraying solution	<ul style="list-style-type: none"> Can you hear the pump running? 	<ul style="list-style-type: none"> If no, please contact your Service Agent.
	<ul style="list-style-type: none"> Solution tank is empty 	<ul style="list-style-type: none"> If yes, see below.
	<ul style="list-style-type: none"> Solution feed filter is blocked 	<ul style="list-style-type: none"> Fill solution tank Check the solution feed filter for blockages and signs of damage
Machine is not spraying solution evenly	<ul style="list-style-type: none"> Spray nozzle is blocked 	<ul style="list-style-type: none"> Check the spray pipe and nozzle for blockages and signs of damage
	<ul style="list-style-type: none"> Solution feed filter is blocked 	<ul style="list-style-type: none"> Check the solution feed filter for blockages and signs of damage
Loss of vacuum suction	<ul style="list-style-type: none"> Recovery tank is full 	<ul style="list-style-type: none"> Empty recovery tank
	<ul style="list-style-type: none"> Blocked hose or wand 	<ul style="list-style-type: none"> Check the wand and hose for blockages and signs of damage

* If the fuse blows several times, the machine should be checked by an authorised Service Agent.

PLEASE REFER TO THE BACK OF THE MANUAL FOR PICTORIAL INSTRUCTIONS

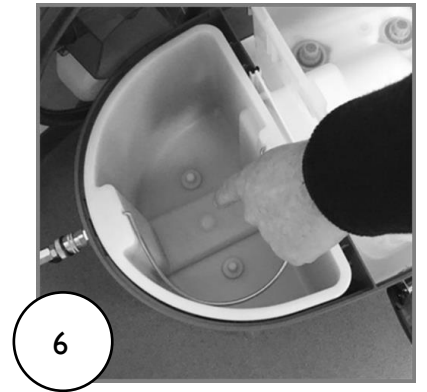
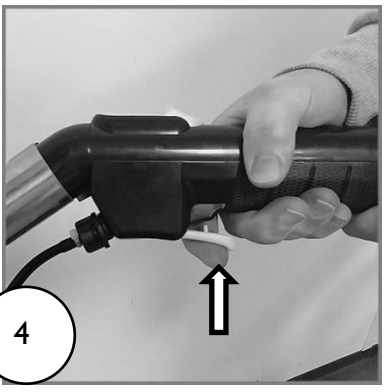
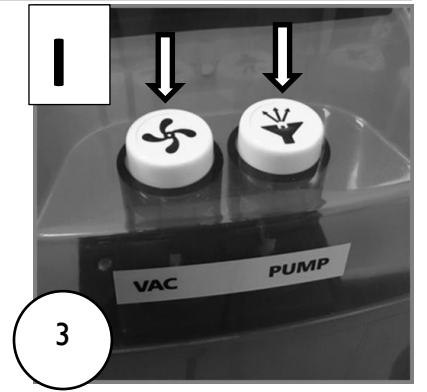
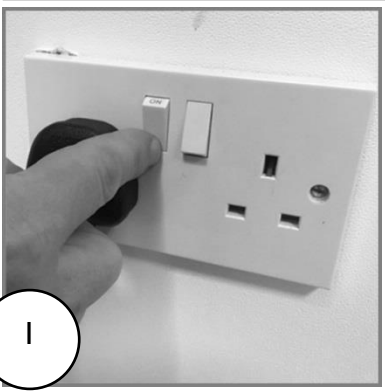
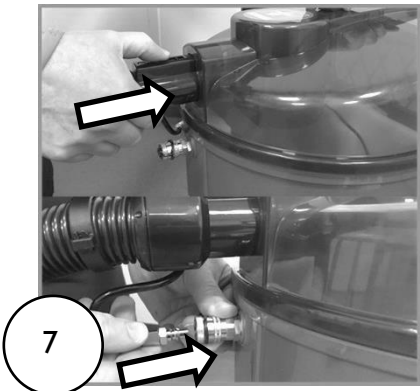
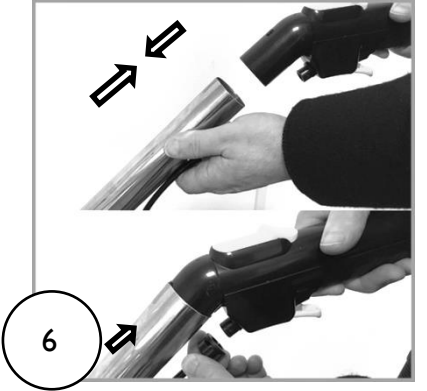
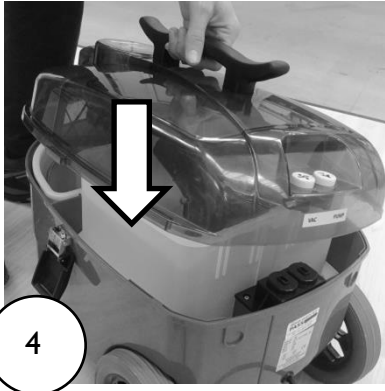
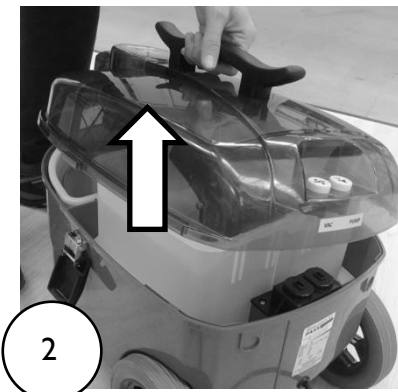
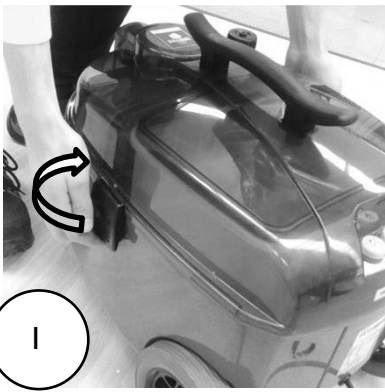

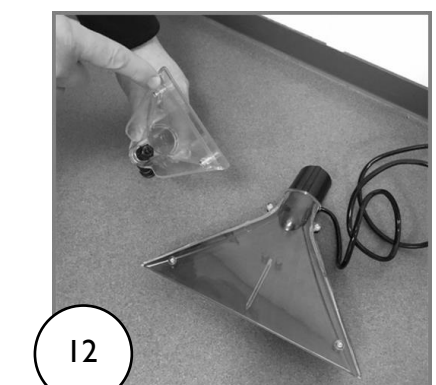
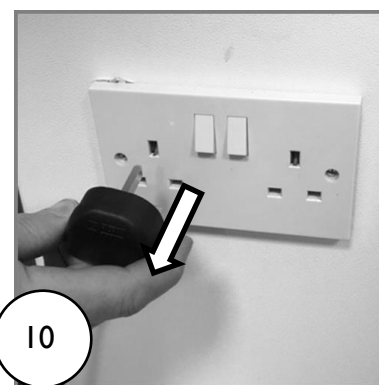
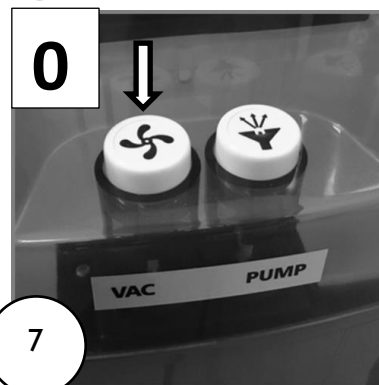
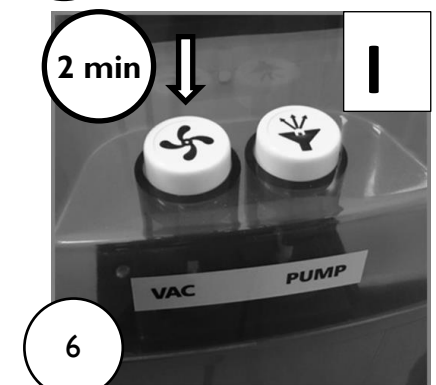
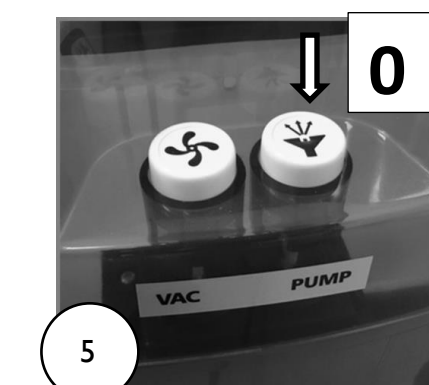
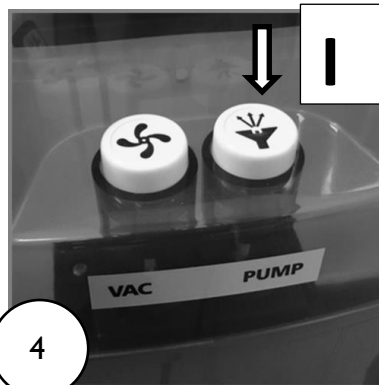
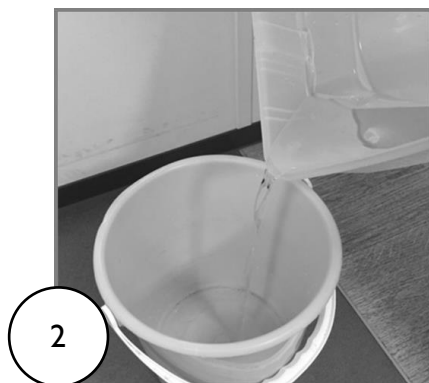
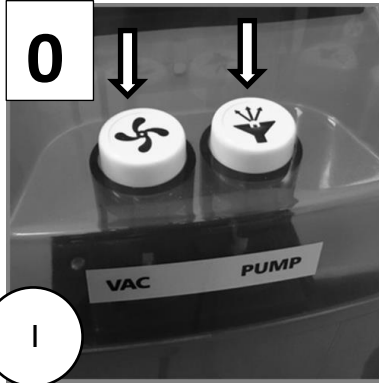

13

